

BE34 Stavex

Large flange head · Steel body · Steel stem · Multi-grip
4.8 mm (3/16")

Features

- High shear and tensile strength provides strong, vibration resistant joints
- Multi-grip capability accommodates wide variations in material thickness
- Good hole fill compensates for irregular, oversized, slotted or misaligned holes and can stop movement in non-standard holes
- Retained stem avoids damage, electrical problems or rattling caused by loose stems
- Provides a large blind side bearing area against the rear sheet
- Spreads the tail bearing load/clamp load on the rear sheet making it ideal for use in thin sheet materials

Material

- Body: Low carbon steel, zinc plated
- Stem: Low carbon steel, zinc plated

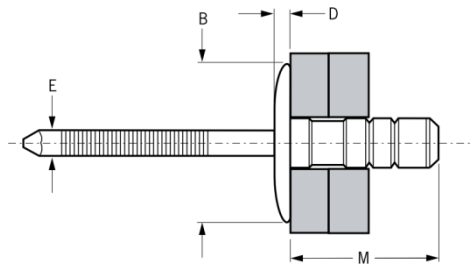

Before Placement

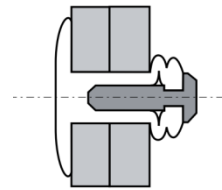

After Placement

Part No.	Size ø	Grip Range		Hole Size		M	øB	D	øE	Shear (min.) kN	Tension (min.) kN
		min.	max.	min.	max.						
0BE34-00614	4.8 (3/16")	1.50	6.35	4.9	5.0	13.8	16.2	2.1	3.0	2.60	2.88
0BE34-00618		1.50	9.00			17.1					
0BE34-00622		6.30	12.70			20.1					



Can't find what you are looking for?

We can provide customized finishing and colouring.
Contact your nearest [Gripwell](#) team for assistance!